

Planting Beds A - J

Scale 1:20

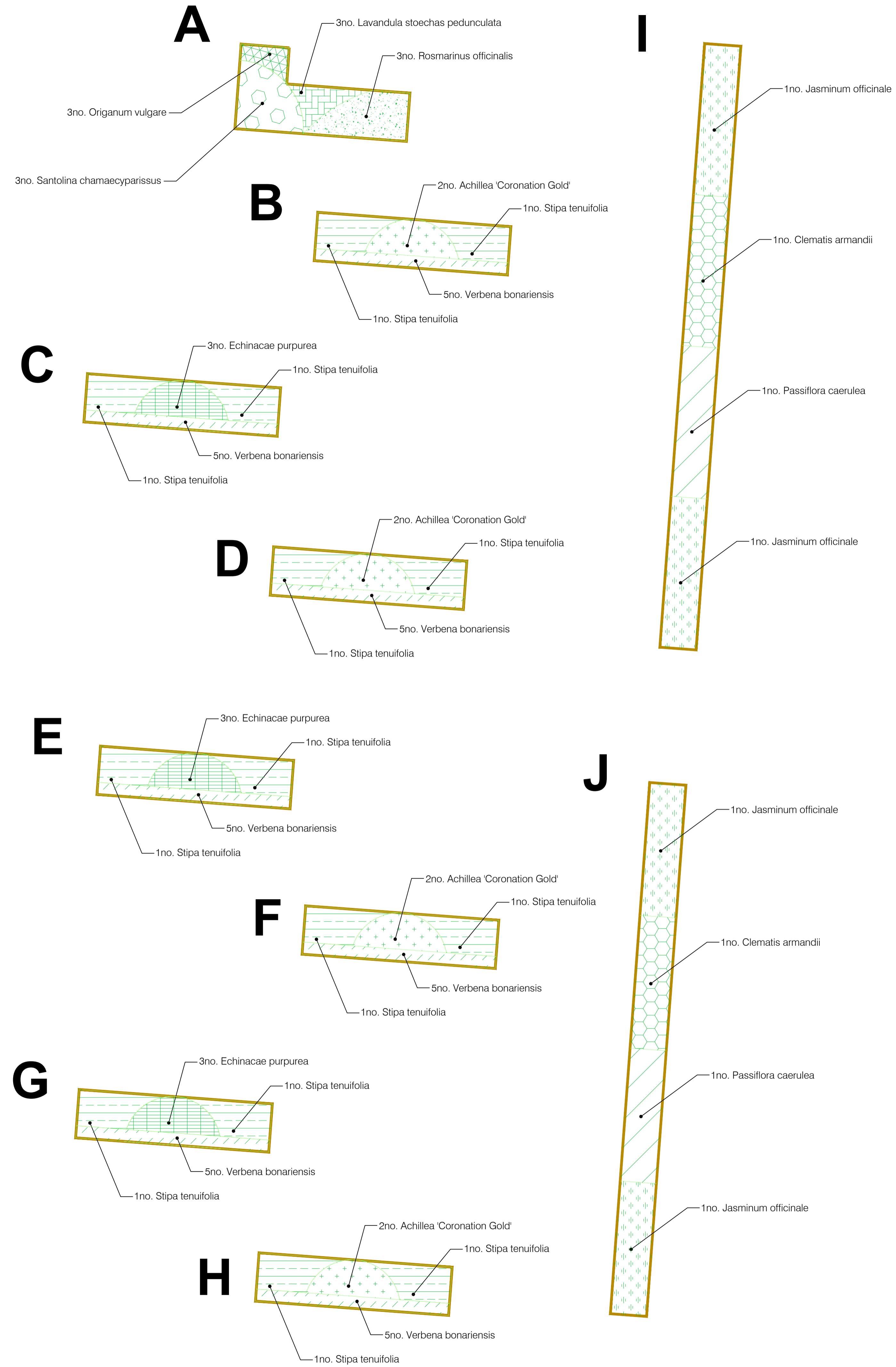

Plan

Scale 1:100

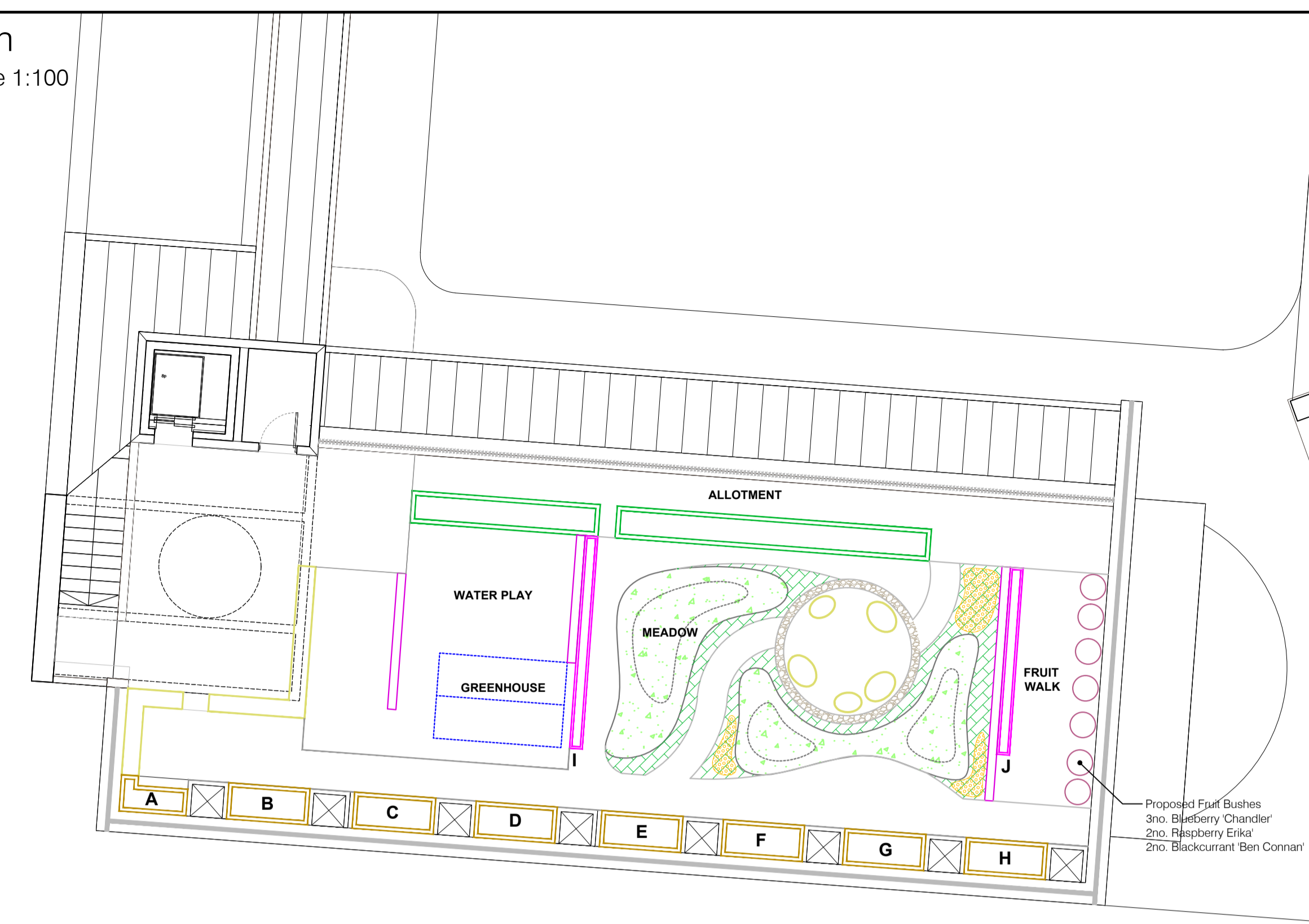

Key

- Proposed Fruiting Bush
Mix of blueberry, raspberry and blackcurrant. See schedule.
- Proposed Turfing
Locally cultivated turf to edges of mounds. Total Area 10m²
- Proposed Wildflower Meadow
Seasonal wildflowers sown on mounds. Emorsgate Seeds EM3 - Special General Purpose Meadow Mixture. Sown at 1.5 g/m². Total Area 18m²
- Proposed Bulb Planting
Seasonal bulbs planted in swathes within turf. Planted in a random mix at 25 per sqm. Total 2m². See schedule.
- Proposed Screen
Hardwood timber / galvanised steel. Height 1800mm, varying lengths.
- Proposed Raised Planter - Allotment
400mm high, 750mm deep, varying lengths, with base, hardwood timber. Lighter Spec Modular Planter System. Supplied by Woodscape or equal approved.
- Proposed Raised Planter - Shrub/Perennial
400mm high, 500mm depth, 1900mm length, hardwood timber. Supplied by Woodscape or equal approved.
- Proposed Raised Planter - Climbers
300mm high, 300mm depth, varying lengths mm hardwood timber. Supplied by Woodscape or equal approved.
- Proposed Greenhouse
Halls Popular 4x6 Greenhouse. Supplied by Greenhouse Warehouse or equal approved.

Specification

GENERAL

Proposals to be read in conjunction with Architects and Engineers Drawings.

All landscape operations to be in accordance with BS 8545: 2014, BS4428: 1989 & BS 3936: 1992 and all amendments to date. Plant material to conform with the National Plant Specification.

Any Plant material planted outside the recognised planting season (Nov-Feb), to be containerised stock and supplied at the sizes specified. Plant handling and planting operations to be in accordance with HTA 'Handling and Establishing Landscape Plants parts I - III'.

All planting to be maintained and guaranteed for 12 months to include watering, weeding, litter picking, pest & disease control.

Any trees, shrubs or hedges planted in accordance with this condition which are removed, die, become severely damaged or become seriously diseased within five years of planting shall be replaced within the next planting season by trees, shrubs or hedging plants of similar size and species to those originally required to be planted. The landscape contractor is to take all safety precautions to prevent any injury to any persons. The landscape contractor shall comply with the requirements of the Health and Safety at Work Act 1974 and current Construction, Design and Management Regulations.

SOIL AND MULCH

Existing topsoil to be stripped and stored on site in heaps not exceeding 2m height and kept weed free;

Any compacted subsoil to be broken up to allow free drainage and to enable topsoil to key into surface;

Any imported topsoil to be to BS3882, weed free, medium texture, neutral PH value, reasonably stone free with no stones over 20mm in size. Finished topsoil levels to be flush with adjacent paved surfaces. Soil depths to be 450mm for shrubs, hedges and groundcover planting and backfill to be a mix of 50/50 approved topsoil and tree and shrub planting compost evenly mixed. Soil depth to be 150mm for grass seeding and turfing (see below for soil mix).

All planting areas to be covered with a 75mm depth of medium grade bark mulch.

PLANT MATERIAL TREATMENT

All to be British grown stock and fully hardened off;

Root Dip - Proprietary Root Dip applied to all bare root stock at time of lifting at nursery and prior to planting.

Anti-Desiccant - Proprietary anti-desiccant to be applied to foliage of all containerised/rootballed material in leaf prior to transportation and during any delay in planting.

SHRUBS, GRASSES, CLIMBERS AND PERENNIALS

All to be planted in pits twice the size of the pot in depth and width and backfilled with a 50-50 topsoil and shrub planting mix.

WATERING

Planting areas are to be brought up to field capacity on completion of planting and during maintenance visits subject to prevailing conditions.

Planting Schedule and Specification

Planting Beds A - H					
Plant Group	Botanical Name	Height cm	Pot Size	Specification	Qty
Shrub	Lavandula stoechas pedunculata	20-30	3L	Bushy; 5 brks	3
Shrub	Origanum vulgare	20-30	2L	Bushy; 5 brks	3
Shrub	Santolina chamaecyparissus	20-30	2L	Bushy; 5 brks	3
Shrub	Rosmarinus officinalis	40-60	5L	Bushy; 5 brks	3
Grasses	Stipa tenuifolia		5L	Full pot	14
Perennials	Achillea 'Coronation Gold'		2L	Full pot	8
Perennials	Echinacea purpurea		2L	Full pot	9
Perennials	Verbena bonariensis		2L	Full pot	15
TOTAL					58

Fruit Bushes					
Plant Group	Botanical Name	Height cm	Pot Size	Specification	Qty
Shrub	Blueberry 'Chandler'	30-40	3L	Bushy; 5 brks	3
Shrub	Raspberry 'Erika'	20-30	5L	5no. canes	2
Shrub	Blackcurrant 'Ben Connan'	60-80	5L	Several shoot; 3brks	2
TOTAL					7

Bulb Planting			
Plant Group	Botanical Name	Specification	Qty
Bulbous	Crocus chrysanthus 'Snow Bunting'	Grade 5/7	10
Bulbous	Galanthus nivalis	Grade 5/6	10
Bulbous	Narcissus 'February Gold'	Grade 8/10	15
Bulbous	Narcissus 'Thalia'	Grade 8/10	15
TOTAL			50

Climbers Beds I - J			
Plant Group	Botanical Name	Specification	Qty
Climber	Clematis armandii	60-80 3L Caned; several shoots; 2 breaks	2
Climber	Jasminum officinale	60-80 2L Caned; several shoots; 2 breaks	4
Climber	Passiflora caerulea	60-80 3L Caned; several shoots; 2 breaks	2
TOTAL			8

North Arrow

This document should not be relied on or used in circumstances other than those for which it was prepared and for which Tyler Grange accepts no responsibility for the document for any party other than the person by whom it was approved.

Client: **Thornsett**

Project Name: **Hackney New Primary School**

Drawing Title: **Sensory Garden / Allotment Detailed Planting Proposals**

PLANNING

TG Tyler Grange

Ladyfild House, Station Road, Wilmslow, Cheshire, SK9 1BB

01625 525 771 | 01625 525 772 | www.tylergrange.co.uk

Scale: VARIOUS @ A1	Date: August 2016
Drawn by: JL	Checked by: JL
Project No: 10312P09	Revision: A